

ROHS

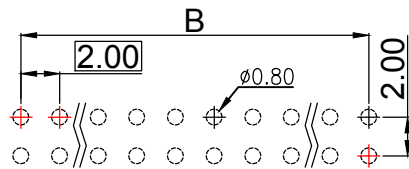

PCB Layout
(Top View)

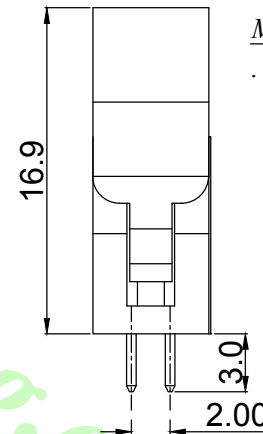
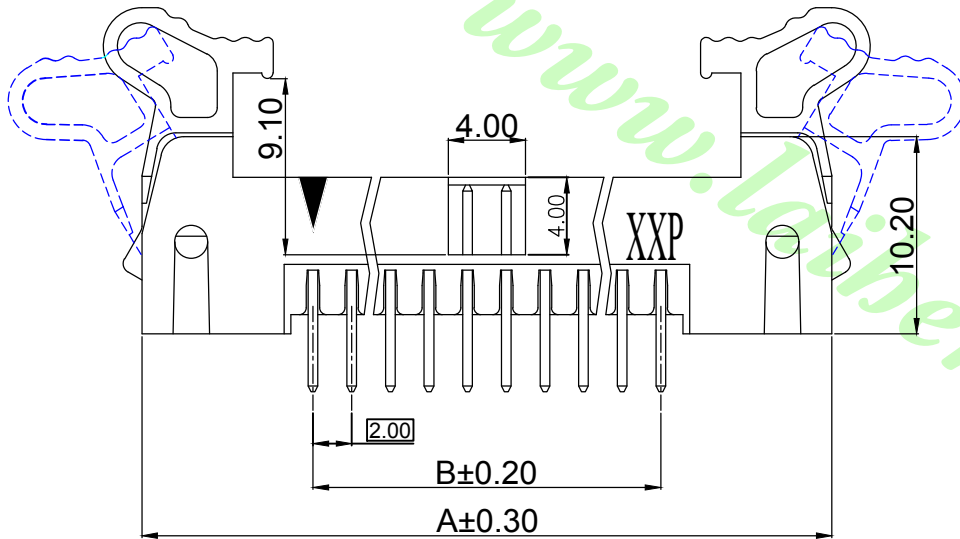
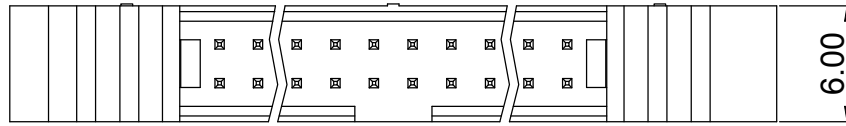
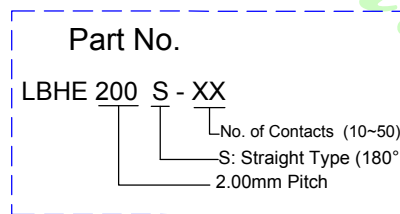

SPECIFICATIONS

MATERIAL AND FINISH

. Housing: Nylon 6T, UL94V-0, Color-Black.

. Terminal: Sq 0.50mm, Brass, Gold Plating.

ELECTRICAL CHARACTERISTICS

. Current Rating: 1.0 Amp. Max.

. Dielectric Withstanding Voltage: 800V AC RMS for 60 Seconds.

. Insulator Resistance: 1000M Ohms Min at 500V DC.

MECHANICAL CHARACTERISTICS

. Operation Temperature: -55°C to +105°C.

Order Information	Dimensions		
	Pos.	A	B
LBHE200S-10	10	25.70	8.00
LBHE200S-12	12	27.70	10.00
LBHE200S-14	14	29.70	12.00
LBHE200S-16	16	31.70	14.00
LBHE200S-20	20	35.70	18.00
LBHE200S-22	22	37.70	20.00
LBHE200S-24	24	39.70	22.00
LBHE200S-26	26	41.70	24.00
LBHE200S-30	30	45.70	28.00
LBHE200S-34	34	49.70	32.00
LBHE200S-40	40	55.70	38.00
LBHE200S-44	44	59.70	42.00
LBHE200S-50	50	65.70	48.00

		公差/UNLESS OTHERWISE SPECIFIED TOLERANCES ARE		單位/Unit	品名/Title :	
		.X ±0.30		mm	2.00mm Box Header Ejector Type PCB Mount	
		.XX ±0.20		比例/Scale	Vertical With Short Latch	
		.XXX ±0.10		Free	料號/Part No :	
A0	NEW DRAWING	2019.03.05		Size	圖號/Drawing No :	
REV	概述/REVISION	日期/DATE		A4	LBHE200S-XX	
				HD22170526-002XX		

鍊亨電子有限公司
 LAI HENG TECHNOLOGY LTD.
 TEL:(02) 8228-6487 FAX:(02) 8228-6486
 核准/APPD. Joe 審核/CHKD. Joe 製圖/DR. Mandy 張數/Sheet 1 of 1 REV. A0